

LEGEND	
	PAVED AREA (PROPOSED)
	CONCRETE (PROPOSED)
	EXIST
	PROP
	EDGE PAVING
	FENCE
	CONTOUR
	PROPERTY LINE
	WATER
	SANITARY SEWER
	STORM DRAIN
	OVERHEAD PWR

GENESEE PROPANE BULK PLANT

412 23RD ST SE

PUYALLUP, WA 98372

PARCEL: 2105200303

PROJECT DETAILS

OWNER
 GENESEE ENERGY
 3616 S GENESEE ST
 SEATTLE, WA 98118

CIVIL ENGINEER
 COLLIN MCMASTER, PE
 VECTOR ENGINEERING, INC
 2729 BLACK LAKE BLVD SW
 TUMWATER, WA 98512
 PHONE: (360) 352-2477

SITE ADDRESS
 412 23RD ST SE
 PUYALLUP, WA 98372

JURISDICTION
 CITY OF PUYALLUP

LEGAL DESCRIPTION

LOT 17 AND THE WEST 80 FEET OF LOT 18, ACKERSON'S 2ND ADDITION TO PUYALLUP, ACCORDING TO THE PLAT THEREOF RECORDED IN BOOK 8 OF PLATS AT PAGE 25; EXCEPT THE NORTH 165 FEET OF THE WEST 150 FEET OF LOT 17; AND EXCEPT FOR ROAD THE WEST 80 FEET OF THAT PORTION OF LOT 17 LYING SOUTH OF THE NORTH 165 FEET THEREOF, RECORDS OF PIERCE COUNTY; SITUATE IN THE COUNTY OF PIERCE, STATE OF WASHINGTON.

EXCEPT THE NORTHERLY 165 FEET THEREOF.

SITE INFORMATION

SITE AREA: 49,311SF / 1.13 ACRES
SITE ZONING: ML (LIMITED MANUFACTURING)

STANDARDS:
 MINIMUM LOT AREA: 10,000 SF
 FRONT YARD SETBACK: 20'
 SIDE YARD SETBACK: 0'
 REAR YARD SETBACK: 0'
 LOT COVERAGE: 65%
 MAXIMUM BUILDING HEIGHT: 50'

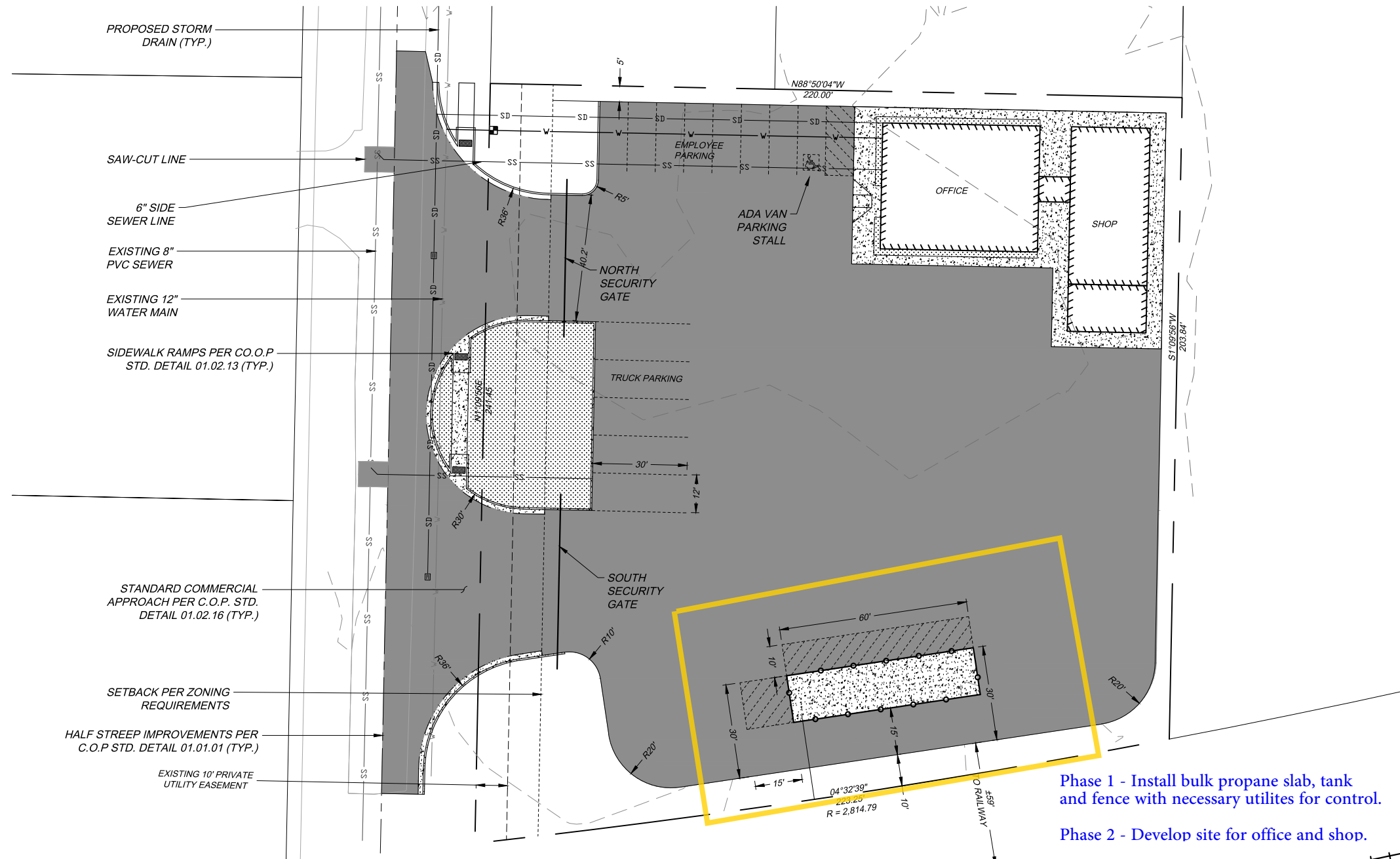
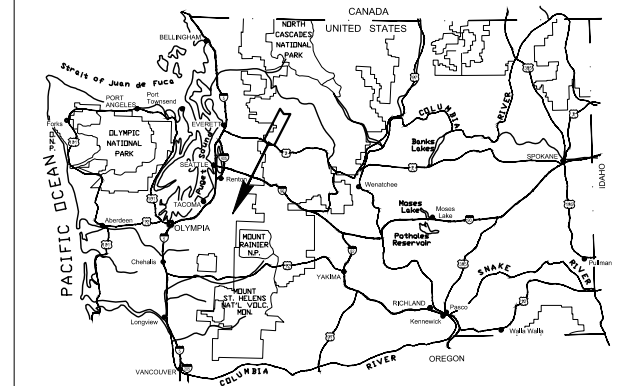

COVER
 SP-1 SCALE: 1" = 40'

C:\Users\cmcmaster\VECTOR\appdata\local\temp\AcPublish_6852.SP_1.dwg - Jul 14, 2021 - 7:48am

FILE: SP_1.dwg				
PROJECT: 21-GEN				
CHECKED BY: CJM				
DETAILED BY: CJM				
DESIGNED BY: CJM	DATE	NO.	REVISION	BY

PRELIMINARY

Vector
 ENGINEERING INC.
 2724 Black Lake Boulevard SW Suite 202
 Tumwater, WA 98512
 ph: (360) 352-2477 fax: (360) 352-0179 E-mail: admin@vectorengineeringinc.com

GENESEE PROPANE BULK PLANT
 412 23RD ST SE
 PUYALLUP, WA 98372

GENESEE ENERGY
 3616 S GENESEE ST
 SEATTLE, WA 98118

SP-1
 SITE PLAN
 SHT 1 OF 1