

arc
 architecture resource collaborative
 119 MAIN ST, STE #200
 SEATTLE, WA 98104-2579
 (206) 322-3322

M I G
 119 PINE STREET, SUITE 400
 SEATTLE, WA 98101
 T 206.223.0326
 www.migcom.com

LEGEND

	PROPOSED BUILDING
	TREE PROTECTION
	SPOT ELEVATION
	SANITARY SEWER SERVICE
	SANITARY SEWER CLEANOUT
	SLOTTED STORM DRAIN
	CATCH BASIN TYPE 1
	AREA DRAIN
	BUILDING DOWNSPOUT
	ASPHALT PAVEMENT
	CONCRETE SIDEWALK

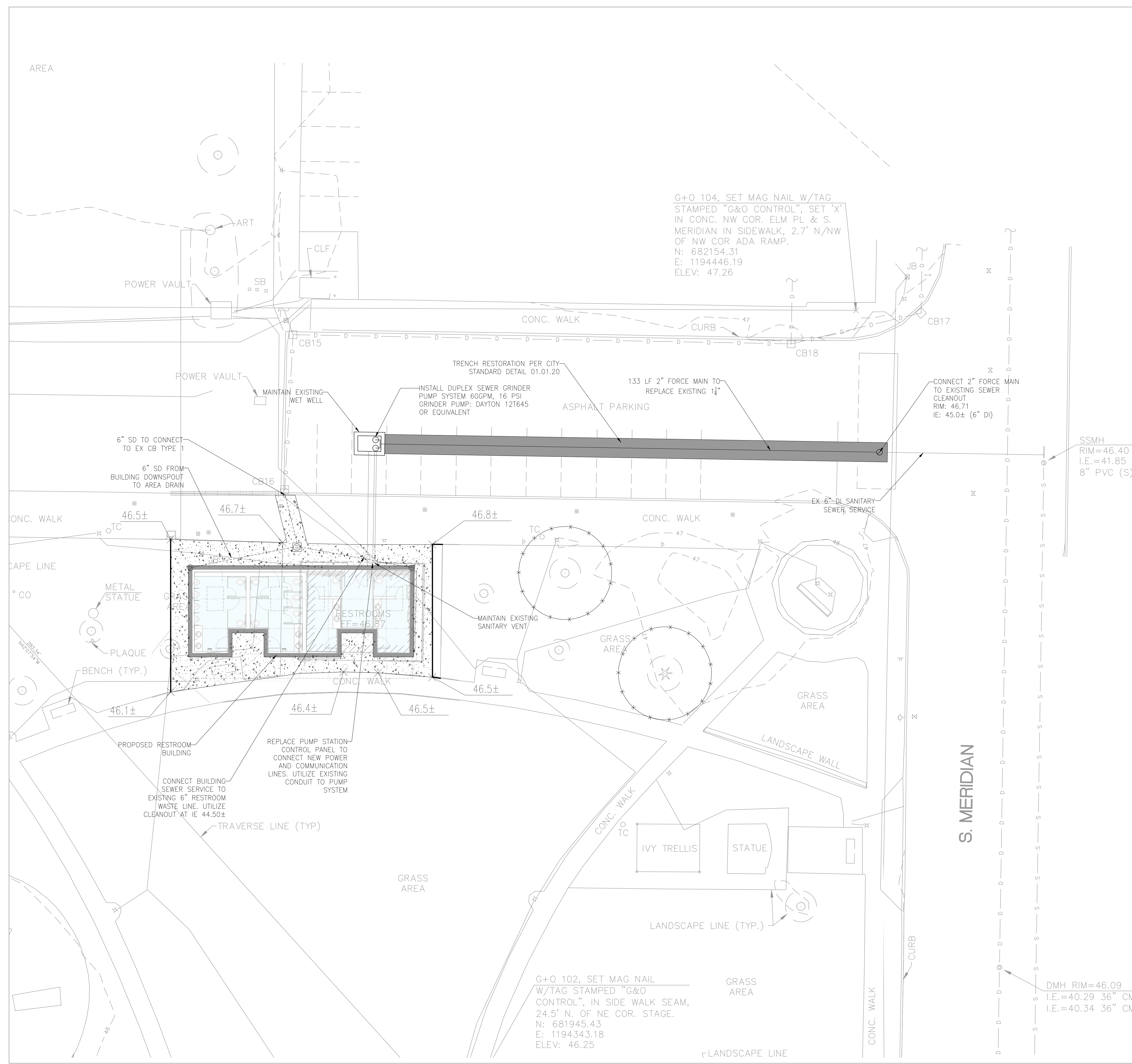

**PIONEER PARK
 RESTROOM UPDATES**

324 S MERIDIAN
 PUYALLUP, WA 98371

**DESIGN
 DEVELOPMENT**

ISSUE DATE: MARCH 31, 2022

REVISION	DATE	DESCRIPTION

CONTENTS:
**PAVING, GRADING,
 AND UTILITY PLAN**

SCALE: 1" = 10'-0"
 DRAWN: AT
 CHECKED: MD
 PROJECT NO: 0000000.00

SHEET:
C1.0