

# Bradley Heights

Section 3, Township 19 N, Range 4 E, Willamette Meridian, Pierce County, Washington

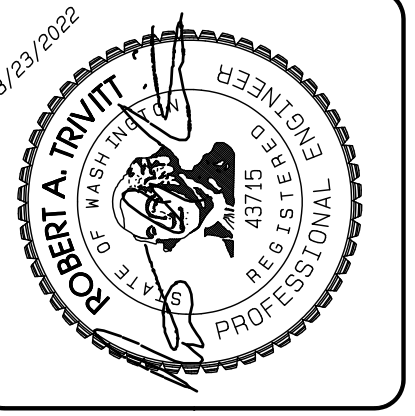

NO.	DESCRIPTION	DATE
1	Added riser rooms, added FDC & PIV symbols.	8/23/22
2		
3		
4		
5		
6		
7		
8		
9		
10		

JOB NO. 3227
DATE: March 28, 2022
DESIGNED BY: Rob Trivitt
DRAWN BY: Rob Trivitt
CHECKED BY: Rob Trivitt
APPROVED BY: Rob Trivitt

**AZURE GREEN**  
CONSULTANTS

\*feasibility \*planning \*engineering \*surveying

409 East Pioneer, Suite A - Puyallup, WA 98372    phone: 253.770.3144    fax: 253.770.3142

**Preliminary SS & Water Plan**

**Bradley Heights**

Timberlane Partners  
1816 11th Ave Unit C  
Seattle, WA, 98122  
Phone  
Fax

DRAWING  
**PRE-2**

SHEET 2  
OF 2

- LEGEND**
- S — PROPOSED SEWER MAIN OR SERVICE
  - ⊙ PROPOSED SEWER MANHOLE
  - W — PROPOSED WATER MAIN
  - M — PROPOSED DOMESTIC WATER SERVICE & METER
  - F — PROPOSED FIRE SERVICE OR FDC LINE
  - ⊕ PROPOSED FIRE HYDRANT
  - Y PROPOSED FDC
  - ▲ PROPOSED PIV
  - ☒ RISER ROOM LOCATION

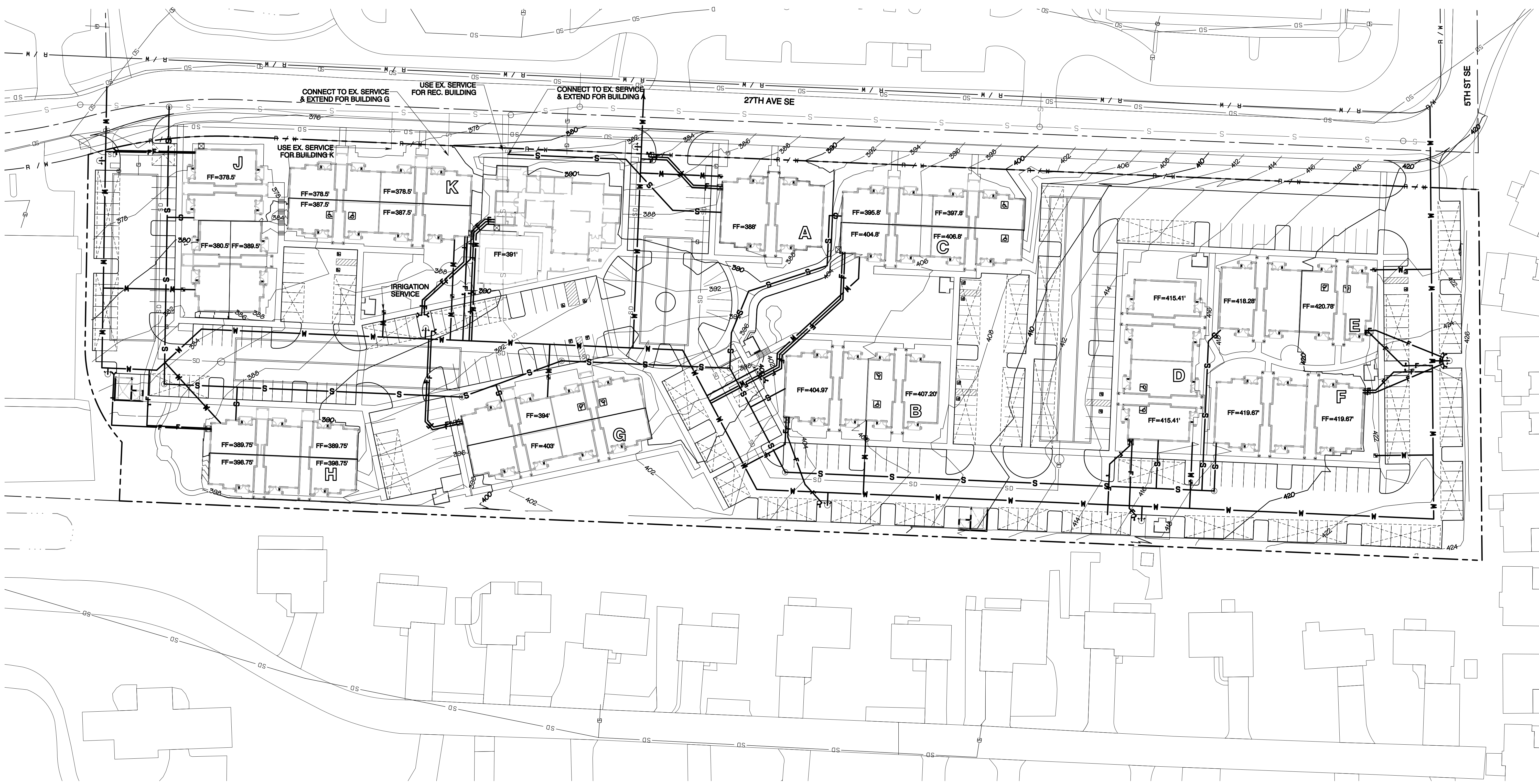
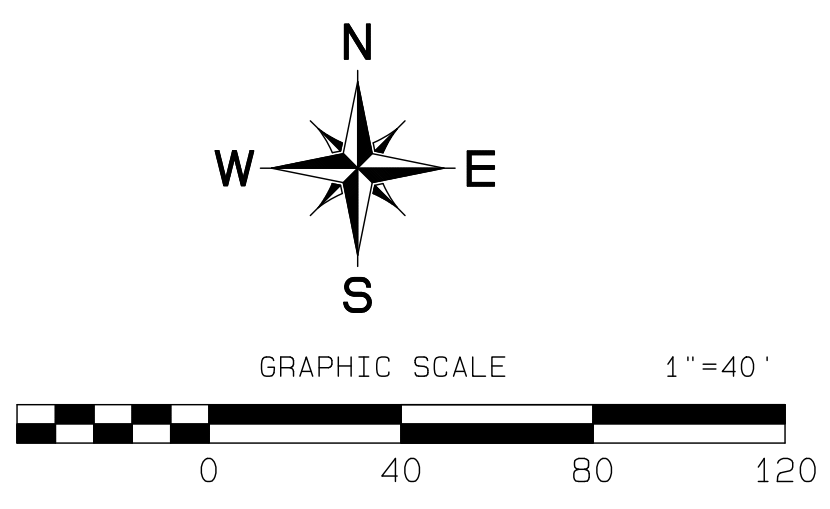

Project Desc.: Bradley Heights    Date: E:\sub\3227 - Bradley Heights\Timberlane\Bradley Heights 2022 0823 0823.dwg    P104 Date/Time: 8/23/2022 5:00:20PM