

SITE INFORMATION, OPTION C2

BUILDING A FOOTPRINT = 406,200 SF
 BUILDING B FOOTPRINT = 242,700 SF
 TOTAL PROPOSED BUILDING = 648,900 SF
 TOTAL SITE AREA = 33.61 ACRES
 SITE BUILDING COVERAGE = 44.3 PERCENT

SITE ZONING = ML W / AG OVERLAY

STORM DETENTION POND = 69,600± SF

TRAILER STORAGE YARD = 103 STALLS

TRUCK DOORS:
 BUILDING A = 115 DOCK
 BUILDING B = 4 DRIVE-IN
 64 DOCK
 4 DRIVE-IN
 179 DOCK
 8 DRIVE-IN

TOTAL DOORS = 282 STALLS

PARKING REQUIREMENTS:
 OFFICE AREA = 20,500 SF
 (1 STALL : 300 SF OFFICE) = 69 STALLS

WAREHOUSE AREA = 628,400 SF
 (1 STALL : 3,000 SF W/HS) = 209 STALLS

TOTAL STALLS REQUIRED = 278 STALLS
 TOTAL STALLS PROVIDED = 282 STALLS

LANDSCAPE REQUIREMENTS:
 20' FRONTAGE STRIP AT VALLEY
 12' PERIMETER STRIP AT 27TH
 10' PERIMETER STRIP ALL ELSE

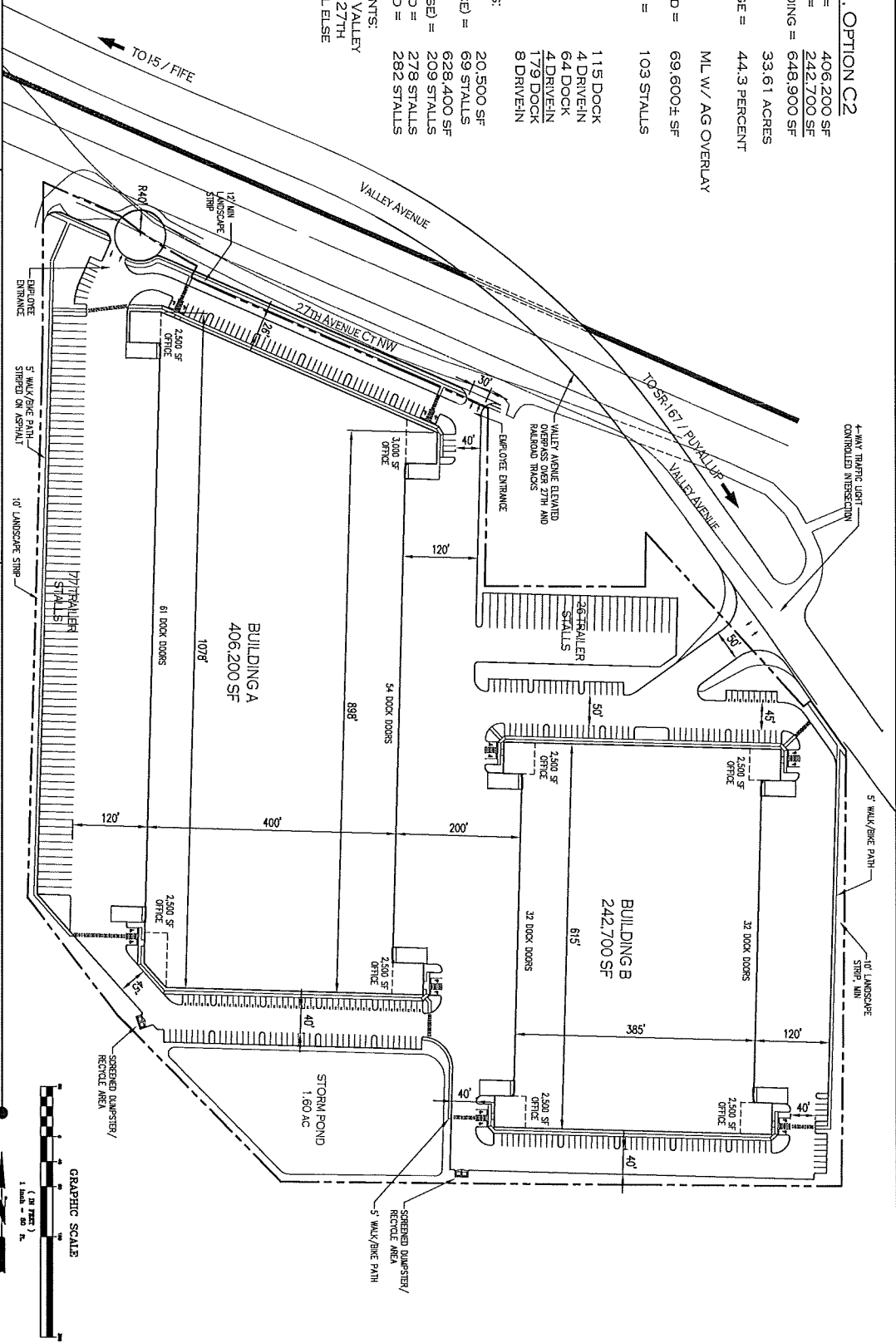

INNOVA architects
 INNOVA ARCHITECTS
 950 PACIFIC AVENUE, SUITE 450
 TACOMA, WA 98402
 253-572-4903

TARRAGON
 TARRAGON
 601 UNION STREET, SUITE 3500
 SEATTLE, WA 98101
 206-233-9600

PROJECT:
TARRAGON - PUYALLUP
 DATE: FEBRUARY 29, 2012 • SHEET TITLE: SITE PLAN • SCALE: 1" = 80'

