

TACO TIME PUYALLUP

EAST MAIN STREET

PUYALLUP, WA 98372

PERMIT SET - 2.11.2022

PROJECT TEAM

OWNER
TACO TIME NORTHWEST
3300 MAPLE VALLEY HIGHWAY
RENTON, WA 98058
CONTACT: CHRIS TONKIN
PHONE: 425.226.6656
FAX: 425.228.8226
EMAIL: chris@tacotimenw.com

ARCHITECTURAL
BCRA, INC
2106 PACIFIC AVENUE, SUITE 300
TACOMA, WA 98402
CONTACT: HEIDI KIHLMAN
PHONE: 253.627.4367
EMAIL: HKIHLMAN@BCRADESIGN.COM

STRUCTURAL
BCRA, INC
2106 PACIFIC AVENUE, SUITE 300
TACOMA, WA 98402
CONTACT: BLAKE JOHNSON
PHONE: 253.627.4367
EMAIL: BJOHNSON@BCRADESIGN.COM

CIVIL
AZURE GREEN
2106 PACIFIC AVENUE, SUITE 300
TACOMA, WA 98402
CONTACT: BLAKE JOHNSON
PHONE: 253.627.4367
EMAIL: BJOHNSON@BCRADESIGN.COM

LANDSCAPE

2106 PACIFIC AVENUE, SUITE 300
TACOMA, WA 98402
CONTACT: BLAKE JOHNSON
PHONE: 253.627.4367
EMAIL: BJOHNSON@BCRADESIGN.COM

VICINITY MAP

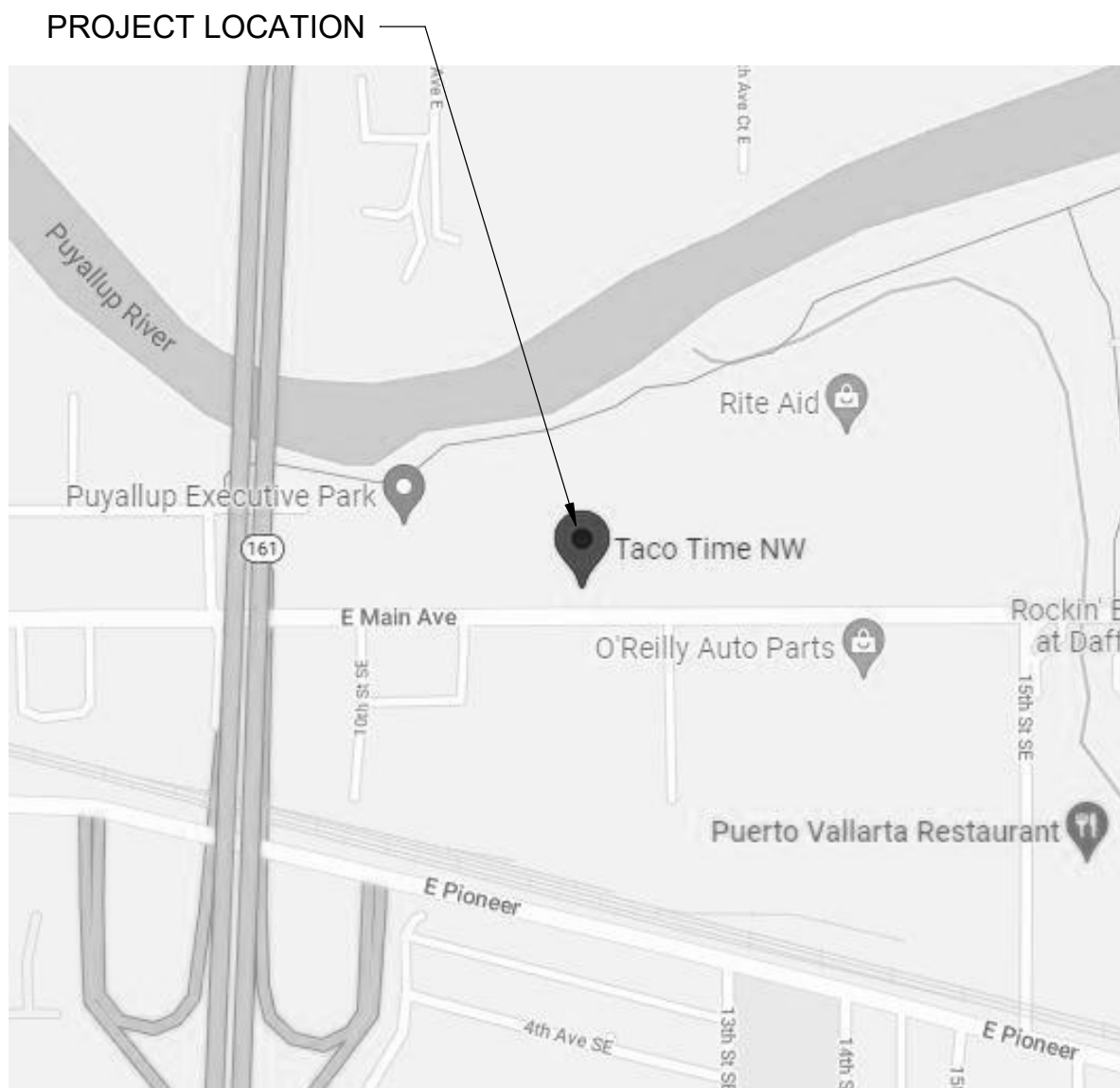

PROJECT INFORMATION

DESCRIPTION	CONSTRUCTION OF NEW TACO TIME WITH DRIVE THRU ON EXISTING SITE.
SITE ADDRESS	EAST MAIN STREET PUYALLUP, WA 98372
LEGAL DESCRIPTION	Section 27 Township 20 Range 04 Quarter 13 SPINNINGS FRANK R REPLAT PARCEL '2' OF DBLR 2003-05-28-5004 DESC AS FOLL S 163.57 FT OF E 124.06 FT OF L 4 & S 163.57 FT OF W 93.01 FT OF L 5 SUBJ TO & TOG/W EASE, RESTRICT & RESERV OF REC OUT OF 003-1, 0 RTSQQ.
PARCEL NUMBERS	7845100032
ZONING	CG
JURISDICTION	CITY OF PUYALLUP
PROJECT SITE AREA	0.82 ACRES
UTILITY PURVEYORS	SEWER: WATER: ELECTRIC: GAS:
CODES UTILIZED	2018 INTERNATIONAL EXISTING BUILDING CODE W WAC AMMENDMENTS 2018 UNIFORM PLUMBING CODE 2018 INTERNATIONAL MECHANICAL CODE 2018 INTERNATIONAL FEUIL GAS CODE 2018 NATIONAL ELECTRIC CODE 2018 INTERNATIONAL ENERGY CONSERVATION CODE W/ WAC AMMENDMENTS CITY OF PUYALLUP
USE	COMMERCIAL
OCCUPANCY TYPE	A-2 ASSEMBLY
CONSTRUCTION TYPE	VB
SPRINKLERED	NO
NUMBER OF STORIES	1
BUILDING HEIGHT	23'-0" HEIGHT (40'-0" ALLOWED)
BUILDING AREA	2,975 SF (6,000 SF ALLOWED)

AIR BARRIER COMPLIANCE

- PERFORMANCE OF BUILDING AIR BARRIER COMPONENTS SHALL MEET THE AIR LEAKAGE REQUIREMENTS OF THE 2018 WSEC SECTION C402.4. THE BUILDING ENVELOPE SHALL BE TESTED ACCORDING TO THE REQUIREMENTS OF WSEC C402.5.1.2 AND AIR LEAKAGE SHALL NOT EXCEED 0.25 CFM/FT AT A PRESSURE DIFFERENTIAL OF 0.3" WATER GAUGE. A REPORT INCLUDING TESTED SURFACE AREA, FLOOR AREA, AIR BY VOLUME, STORIES ABOVE GRADE, AND AIR LEAKAGE RATES SHALL BE SUBMITTED TO THE BUILDING OWNER AND TO THE BUILDING OFFICIAL.
- INSTALL CONTINUOUS AIR BARRIER SYSTEM OVER THE ENTIRE EXTERIOR ENVELOPE (ROOFS, WALLS, AND FLOOR) SEPARATING THE INTERIOR CONDITIONED AIR FROM THE EXTERIOR UNCONDITIONED AIR WITH AN AIR LEAKAGE RATE NOT EXCEEDING 0.25 CFM/SF TO EXTERIOR ENVELOPE AREA AT 75 PA OR 0.3 WG. THE CONTINUOUS BUILDING AIR BARRIER SYSTEM INCLUDES AIR TIGHT CONNECTIONS TO ANY PENETRATIONS, WINDOWS, DOORS, LOUVERS, AND BETWEEN ADJACENT DIFFERENT TYPES OF AIR BARRIER FENESTRATIONS SHALL COMPLY WITH C402.5.1.

ARCHITECTURAL SYMBOLS

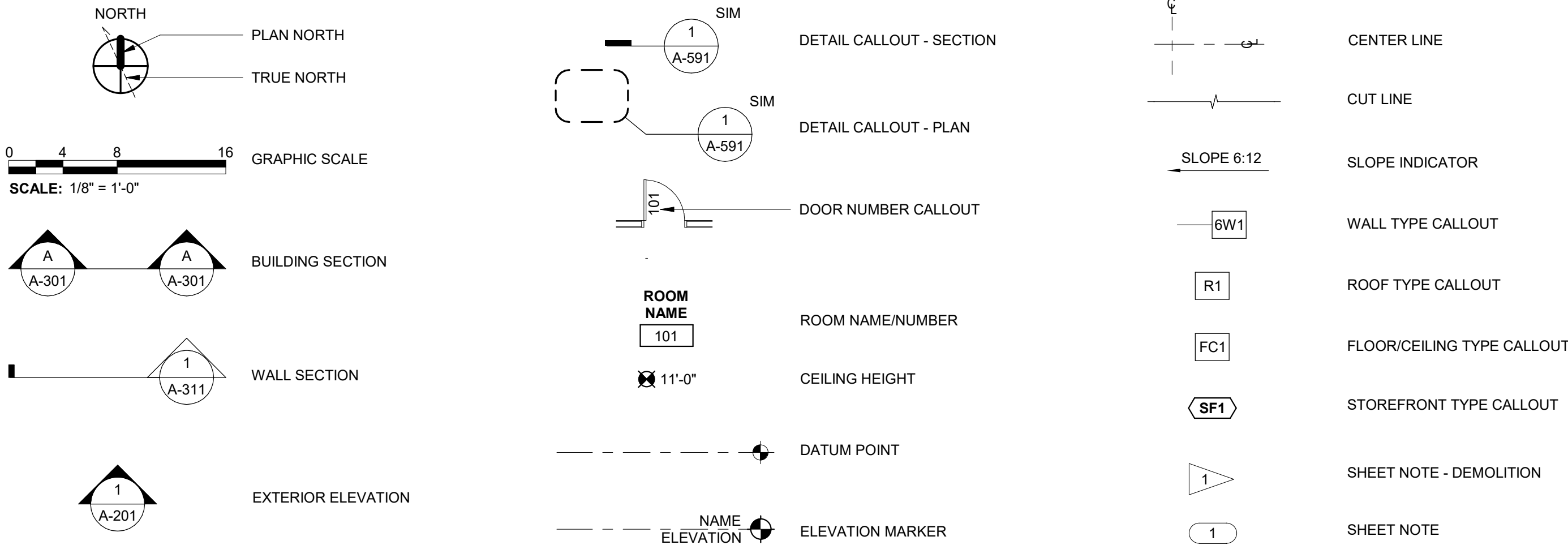

PROJECT GENERAL NOTES

- ALL CONSTRUCTION SHALL COMPLY WITH THE 2017 INTERNATIONAL BUILDING CODE, THE AMERICANS WITH DISABILITIES ACT, AND ALL APPLICABLE LOCAL CODES, ORDINANCES, AND STANDARDS.
- DO NOT SCALE DRAWINGS. DIMENSIONS GOVERN. THE CONTRACTOR SHALL NOTIFY ARCHITECT IMMEDIATELY OF ANY DISCREPANCIES.
- WHERE CONSTRUCTION DETAILS ARE NOT SHOWN OR NOTED FOR ANY PART OF THE WORK, THE DETAILS SHALL BE THE SAME AS FOR OTHER SIMILAR WORK. IF QUESTIONS CANNOT BE RESOLVED IN THIS MANNER, CONTACT THE ARCHITECT PRIOR TO PROCEEDING WITH THE WORK.
- AN APPROVED PUBLIC SAFETY KEY BOX SHALL BE INSTALLED ADJACENT THE MAIN ENTRANCE AND SHALL BE CLEARLY VISIBLE, MOUNTED WITHIN SIX FEET OF THE GRADE, AND APPROVED BY THE LOCAL JURISDICTION. THE KEY BOX SHALL CONTAIN KEYS THAT OPERATE THE ELEVATOR RECALL AND EMERGENCY OVERRIDE SYSTEMS. KEYS SHALL BE CLEARLY MARKED AS FOR WHAT DOOR, ROOM, AREA OR LOCK THEY SERVE. THE KEY BOX SHALL CONTAIN KEYS TO OPEN DOORS OR OTHER ACCESS MEANS AT THE FOLLOWING LOCATIONS:
 - THE MAIN ENTRANCE
 - ROOMS CONTAINING CONTROL VALVES FOR AUTOMATIC SPRINKLER SYSTEMS
 - ROOMS CONTAINING FIRE ALARM SYSTEM CONTROL PANELS
 - ROOMS CONTAINING ELEVATOR EQUIPMENT
 - ROOMS CONTAINING MAIN ELECTRICAL SERVICES PANELS
- WHERE DEVICES OR ITEMS OR PARTS THEREOF ARE REFERRED TO IN SINGULAR IT IS INTENDED THAT SUCH SHALL APPLY TO AS MANY SUCH DEVICES, ITEMS OR PARTS AS ARE REQUIRED TO PROPERLY COMPLETE THE WORK.
- FIELD MEASURE AND CONFIRM DIMENSIONS FOR OWNER PROVIDED EQUIPMENT AND FURNISHINGS.
- PROVIDE STIFFENERS, BRACING, BACKING PLATES AND BLOCKING REQUIRED FOR SECURE INSTALLATION OF GRAB BARS, DOORS AND DOOR HARDWARE INCLUDING WALL-MOUNTED DOOR STOPS, HANDRAILS, WALL-MOUNTED SHELVES, MISCELLANEOUS EQUIPMENT, AND SUSPENDED MECHANICAL AND ELECTRICAL EQUIPMENT.
- COORDINATE AND PROVIDE ALL BASE AND HOUSEKEEPING PADS FOR MECHANICAL, PLUMBING AND ELECTRICAL EQUIPMENT.
- LOCATE ACCESS DOORS IN ACCORDANCE WITH APPLICABLE CODES, SUBMIT PROPOSED LOCATIONS TO THE ARCHITECT FOR REVIEW AND ACCEPTANCE PRIOR TO INSTALLATION.
- FINISH FLOOR ELEVATIONS ARE TO TOP OF CONCRETE AND TOPPING SLAB UNLESS OTHERWISE NOTED.
- COORDINATE EXACT SIZE AND PLACEMENT OF EQUIPMENT BEING PROVIDED.
- THE CONTRACTOR SHALL PROVIDE TEMPORARY BRACING FOR THE BUILDING STRUCTURE AND STRUCTURAL COMPONENTS UNTIL FINAL CONNECTIONS HAVE BEEN COMPLETED IN ACCORDANCE WITH THE CONSTRUCTION DOCUMENTS.
- FIRE BLOCKING AND SMOKE BARRIERS SHALL BE INSTALLED IN ACCORDANCE WITH 2017 INTERNATIONAL BUILDING CODE.

SHEET INDEX

GENERAL	
G-101	COVER
G-102	CODE SUMMARY
G-301	ADA ACCESSIBILITY REQUIREMENTS
ARCHITECTURAL	
A-111	SITE PLAN
A-121	FIRST FLOOR PLAN
A-122	FINISH & EQUIPMENT PLAN
A-123	EQUIPMENT SCHEDULE
A-151	FIRST FLOOR REFLECTED CEILING PLAN
A-161	ROOF PLAN
A-201	EXTERIOR ELEVATIONS
A-211	INTERIOR ELEVATIONS
A-212	INTERIOR ELEVATIONS
A-213	INTERIOR ELEVATIONS
A-301	BUILDING SECTIONS
A-311	WALL SECTIONS
A-312	WALL SECTION
A-351	STOREFRONT DETAILS
A-352	DOOR DETAILS
A-401	ENLARGED FLOOR PLANS
A-541	TYPICAL SEQUENCING OF SHEET-APPLIED AIR / WATER BARRIER SYSTEM AT FLANGELESS WINDOW AND LOUVER OPENINGS
A-542	TYPICAL SEQUENCING OF SHEET-APPLIED AIR / WATER BARRIER SYSTEM AT FLANGELESS WINDOW AND LOUVER OPENINGS
A-551	CEILING DETAILS
A-561	ROOF DETAILS
A-562	ROOF DETAILS
A-591	EXTERIOR WALL DETAILS
A-592	INTERIOR DETAILS
A-593	INTERIOR DETAILS
A-601	INTERIOR FINISH SCHEDULE
A-611	DOOR SCHEDULE
A-621	ASSEMBLY TYPES
STRUCTURAL	
S-101	STRUCTURAL COVER SHEET
S-201	STRUCTURAL SHEET
MECHANICAL	
M-101	MECHANICAL COVER SHEET
M-201	MECHANICAL SHEET
ELECTRICAL	
E-101	ELECTRICAL COVER SHEET
E-102	ELECTRICAL SHEET
PLUMBING	
P-101	PLUMBING COVER SHEET
P-201	PLUMBING SHEET

SEPARATE / DEFERRED SUBMITTALS

SEPARATE:

CIVIL

LANDSCAPE

SIGNAGE

DEFERRED:

ABBREVIATIONS

AFF	ABOVE FINISHED FLOOR	LL	LANDLORD
B.O.	BOTTOM OF	MAX	MAXIMUM
CG	CORNER GUARD	MDF	MEDIUM DENSITY FIBERBOARD
DS	DOWNSPOUT	MIN	MINIMUM
EQ	EQUAL	O.C.	ON CENTER
FV	FIELD VERIFY	OCC	OCCUPANT / OCCUPANCY
GA	GAUGE	SF	SQUARE FOOT / STOREFRONT
GWB	GYPSUM BOARD	T.O.	TOP OF



T 253.627.4367 F 253.627.4366 WWW.BCRADESIGN.COM
2106 PACIFIC AVENUE, SUITE 300, TACOMA, WA 98402

SEA

PROJECT:
NEW CONSTRUCTION
TACO TIME
EAST MAIN STREET
PUYALLUP, WA 98372

REVISIONS

NO.	DATE	DESCRIPTION

DATE
1.3.2022
BCRA NO.
19110.00.00
DRAWN BY:
REVIEWED BY:
SHEET TITLE
COVER



© COPYRIGHT 2019 - BCRA, INC. ALL RIGHTS RESERVED.

G-101

PERMIT SET

IF SHEET MEASURES LESS THAN 24"X36", IT IS A REDUCED PRINT. REDUCE SCALE ACCORDINGLY

1 SITE PLAN
1" = 20'-0"

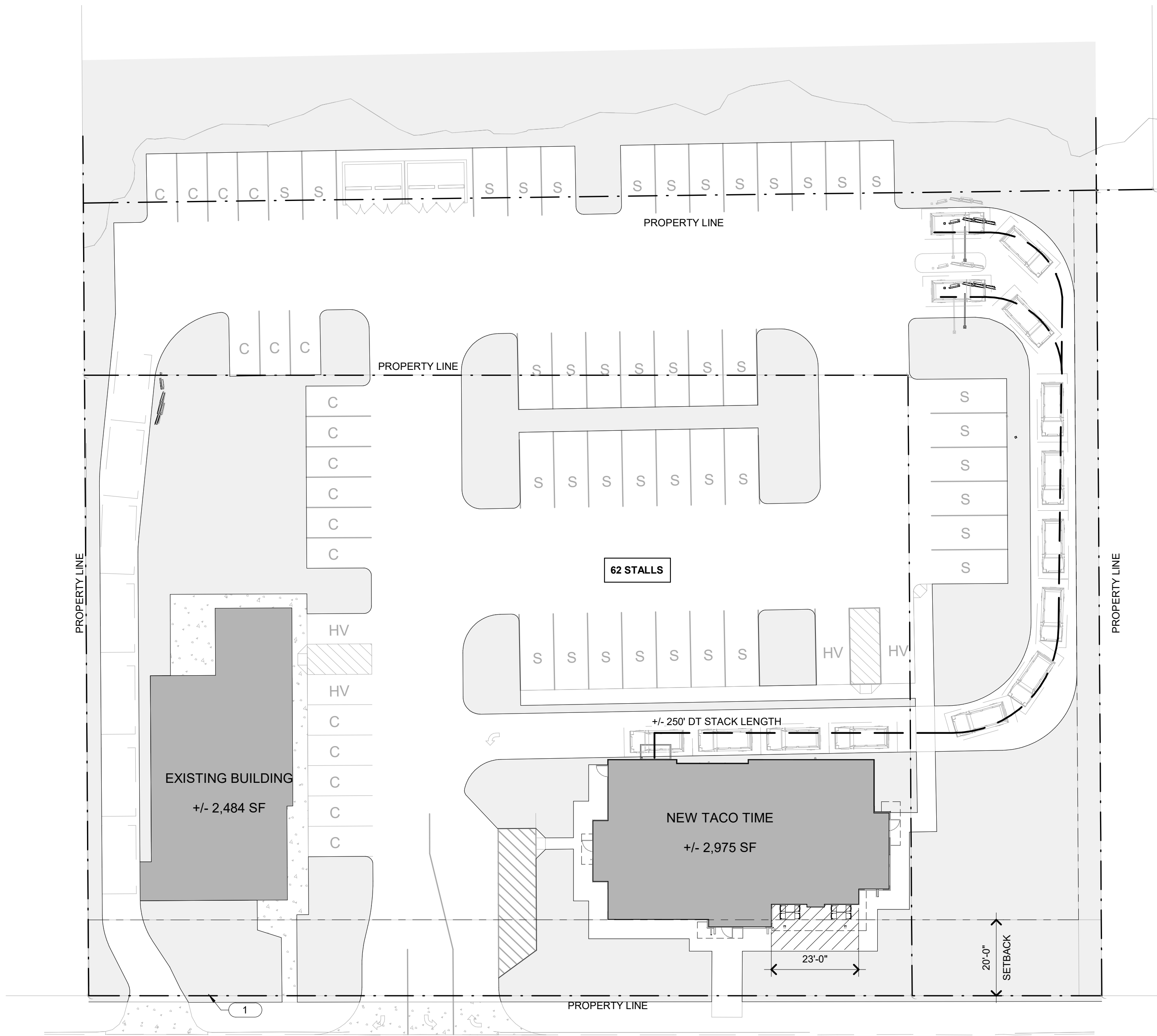

SITE PLAN GENERAL NOTES

1. REFER TO CIVIL DRAWINGS FOR DEMOLITION OF EXISTING STRUCTURES AND SITE FEATURES.
2. REFER TO CIVIL DRAWINGS FOR ASPHALT PAVING AND CONCRETE SIDEWALK SECTIONS.
3. REFER TO CIVIL DRAWINGS FOR ALL SURFACING FEATURES, UTILITIES, GRADING, STORMWATER AND ELEVATIONS. ELEMENTS SHOWN ON THIS DRAWING ARE FOR REFERENCE ONLY.
4. REFER TO LANDSCAPE DRAWINGS FOR PLANTING AND IRRIGATION DESIGN.
5. REFER TO ELECTRICAL DRAWINGS FOR SITE LIGHTING AND EQUIPMENT DESIGN.

SITE PLAN LEGEND

- OUTLINE OF STUCTURE/OVERHANG ABOVE
- . - PROPERTY LINE
- LANDSCAPE AREA

SITE PLAN SHEET NOTES

- 1 PROPERTY LINE